

Building Our Faith...



Together

Chapel in the Pines Presbyterian Church | Chapel Hill, NC

THE MISSION

Acknowledging human need for God's grace and trusting in God's sovereign love, Chapel in the Pines Presbyterian Church located in north Chatham County, NC, extends to all people a warm welcome into a community of faith with a two-fold purpose:

- to worship God with joyful gratitude for God's unending, abiding grace given to all people through God's son, Jesus Christ;
- and to witness, through our gifts of time, talents, intentional inclusiveness, and financial resources, the love of Christ for all people, manifested through the church's work of peacemaking and reconciliation as we grow together in faith.

THE GOAL

Phase One Projected Cost:	\$1,550,000
Three-Year Campaign Goal:	750,000
Cash to Begin Construction:	387,500
Cash on Hand:	- 103,000
Net Remaining:	<u>\$ 285,500</u>

Financing:

Cost:	\$1,550,000
Down Payment (25%):	387,500
Mortgage:	1,200,000

Outreach: 10% of amount pledged

THE PLAN



FRONT ELEVATION

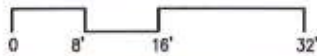

Floor plan on reverse →



SIDE ELEVATION

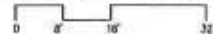

THE PLAN

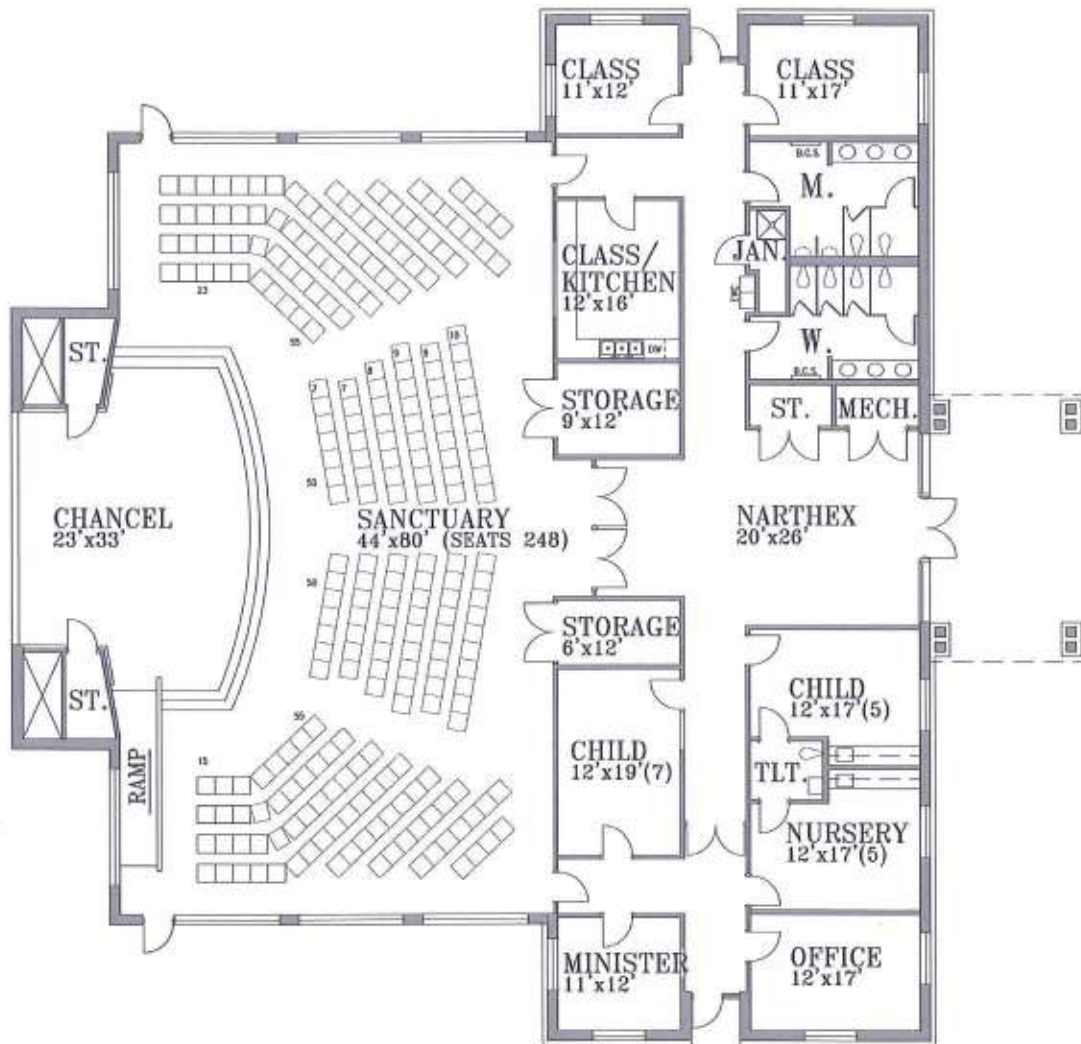

PROPOSED PHASE I CHURCH

8200 sf

16 APR 2010



NORTH

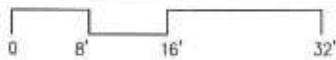

THE NEED

The Church is a people before it is a building.

The building is a worship space to serve the community.

It is a starting point, not the destination.

FULFILLING OUR NEEDS

Chapel in the Pines has a need for a church building in order to:

- provide a place for the worship of God and for the spiritual growth for our entire church family and the community;
- be welcoming, available and accessible throughout the week/year;
- provide space for a broad range of church-related activities including worship, education, fellowship, pastoral care, meetings, child-care, baptisms, weddings, and funerals;
- enhance and encourage the growth of the Body of Christ;
- consolidate all office and meeting spaces at one location;
- expand our church school facilities and activities;
- provide meeting space for community organizations.

THE HISTORY

The History of a Dream:

In the mid-1990s, Robert Dunham, pastor of University Presbyterian Church (UPC) in Chapel Hill, began to dream of a new church that would grow out of UPC. He and other pastors and members of UPC began conversations about the growth in north Chatham County, just south of Chapel Hill.

In 2002, a dialogue with Salem Presbytery began since a new church would be in their jurisdiction. The creation of a task force followed. In early 2005, three Task Force members (Bill Browder, Mary Donna Pond, and Rickie Howard) and Mindy Douglas Adams, Associate Pastor of University Presbyterian Church, developed a mission statement, a grant proposal, and a ministry plan. They met with the UPC Session and reached out to the Church of Reconciliation, Pittsboro Presbyterian Church and others for help. In June, the Task Force submitted a grant proposal to Salem Presbytery for approval for funding by the Presbyterian Church (USA) General Assembly. Through the summer, weekly Sunday School classes, monthly fellowship events, and Sunday evening Vesper services took place. In November the General Assembly awarded a \$97,000, five-year grant to the new church. They chose a name: Chapel in the Pines Presbyterian Church. A search committee started a national search for an Organizing Pastor; in February 2006, the committee chose The Reverend Mindy Douglas Adams for that role.

In early 2006, the group worshipped on the first, third and fifth Sunday mornings at Captain John's Dockside Restaurant; and on the second and fourth Sundays at other area churches. On June 5, 2006 (Pentecost Sunday), the Church received its first members. In September, the congregation began worshipping every Sunday morning, and Sunday School classes for children began. "Launch Sunday," held October 1, 2006, drew more than one hundred people.

In early 2007, Sunday morning worship moved to North Chatham School, where it continues. Also in 2007, late summer, Chapel in the Pines entered into a formal agreement with the Lindley family to purchase twelve acres of land off Mann's Chapel Road.

On May 4, 2008, the Church was chartered, its first Elders and Deacons were ordained and installed. The Reverend Mindy Douglas Adams became the church's first pastor.

In January 2009, the land was purchased, and soon the Building/Planning Committee began work with WKWW Architects and Riggs-Harrod Builders on the building design. A Capital Campaign to finance the building began in April 2010.

One hundred twenty-one active members now worship at Chapel in the Pines. The congregation, actively engaged in Habitat for Humanity, Take and Eat Food Pantry, Take and Wear Clothes Closet, and tutoring of local children, is community centered. The congregation has sent members to Guatemala and continues to nurture the relationship with their missionaries there. Chapel in the Pines has celebrated a birth, supported those ill and dying, prayed for the community, celebrated the sacraments of baptism and communion, raised its voices in song, and cared for each other. This vibrant, deeply engaged congregation is in awe of the power of the Holy Spirit; it is thankful for all that God has provided its members; and it looks ahead with hope to a new church home.

A more detailed history is available at <http://citppc.org>, follow the menu to About Us → Our History.

Gifts Needed for \$750,000 for Phase 1 Construction

Total Gift	Needed	Total Needed	Received to Date	Total Committed
\$100,000	1	\$100,000	0	\$0
\$75,000	1	\$75,000	0	\$0
\$50,000	2	\$100,000	0	\$0
\$35,000	3	\$105,000	0	\$0
\$25,000	5	\$125,000	0	\$0
\$15,000	5	\$75,000	0	\$0
\$10,000	5	\$50,000	0	\$0
\$7,000	5	\$35,000	0	\$0
\$5,000	5	\$25,000	0	\$0
\$3,000	8	\$24,000	0	\$0
\$2,000	10	\$20,000	0	\$0
\$1,000	10	\$10,000	0	\$0
<\$1,000	12	\$6,000	0	\$0
Total	72	\$750,000	0	\$0

NOTE: There are 72 households on CITP's membership list.

Gifting Table

Total Gift	Yearly	Quarterly	Monthly	Weekly
\$50,000	\$16,667	\$4,167	\$1,389	\$321
\$45,000	\$15,000	\$3,750	\$1,250	\$289
\$40,000	\$13,333	\$3,333	\$1,111	\$256
\$35,000	\$11,667	\$2,917	\$972	\$224
\$30,000	\$10,000	\$2,500	\$833	\$192
\$25,000	\$8,333	\$2,083	\$694	\$160
\$20,000	\$6,667	\$1,667	\$556	\$128
\$15,000	\$5,000	\$1,250	\$417	\$96
\$10,000	\$3,333	\$833	\$278	\$64
\$9,000	\$3,000	\$750	\$250	\$58
\$8,000	\$2,667	\$667	\$222	\$52
\$7,000	\$2,333	\$583	\$194	\$45
\$6,000	\$2,000	\$500	\$167	\$39
\$5,000	\$1,667	\$417	\$139	\$32
\$4,000	\$1,333	\$333	\$111	\$26
\$3,000	\$1,000	\$250	\$83	\$19
\$2,000	\$667	\$167	\$56	\$13
\$1,000	\$333	\$83	\$28	\$7

As each has received a gift, employ it for one another, as good stewards of God's varied grace.

1 Peter 4:10